

WHEN THE ART OF MAKING SHOES
MEETS CUTTING EDGE TECHNOLOGY

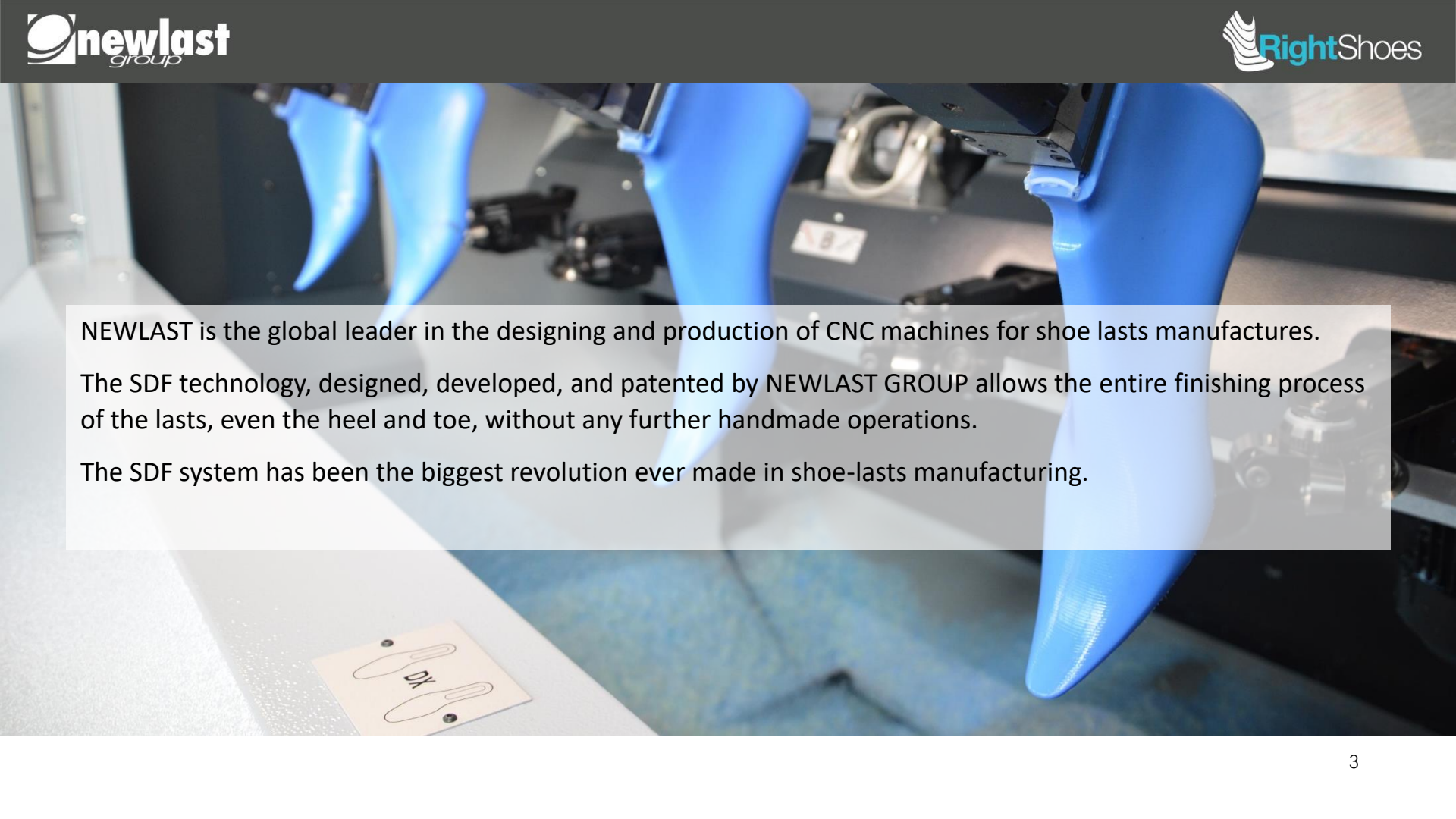

NEWLAST GROUP

The last is the core for the concept, the design and the
production of each shoe

A close-up photograph of a CNC machine in a factory setting. Several bright blue, glossy shoe lasts are being processed by the machine's arms. The machine is dark grey and metallic, with various mechanical components visible. The background is slightly blurred, showing more of the industrial environment.

NEWLAST is the global leader in the designing and production of CNC machines for shoe lasts manufactures.

The SDF technology, designed, developed, and patented by NEWLAST GROUP allows the entire finishing process of the lasts, even the heel and toe, without any further handmade operations.

The SDF system has been the biggest revolution ever made in shoe-lasts manufacturing.

THE RIGHT SHOES PROJECT

From the Perfect Last to the Right Shoes

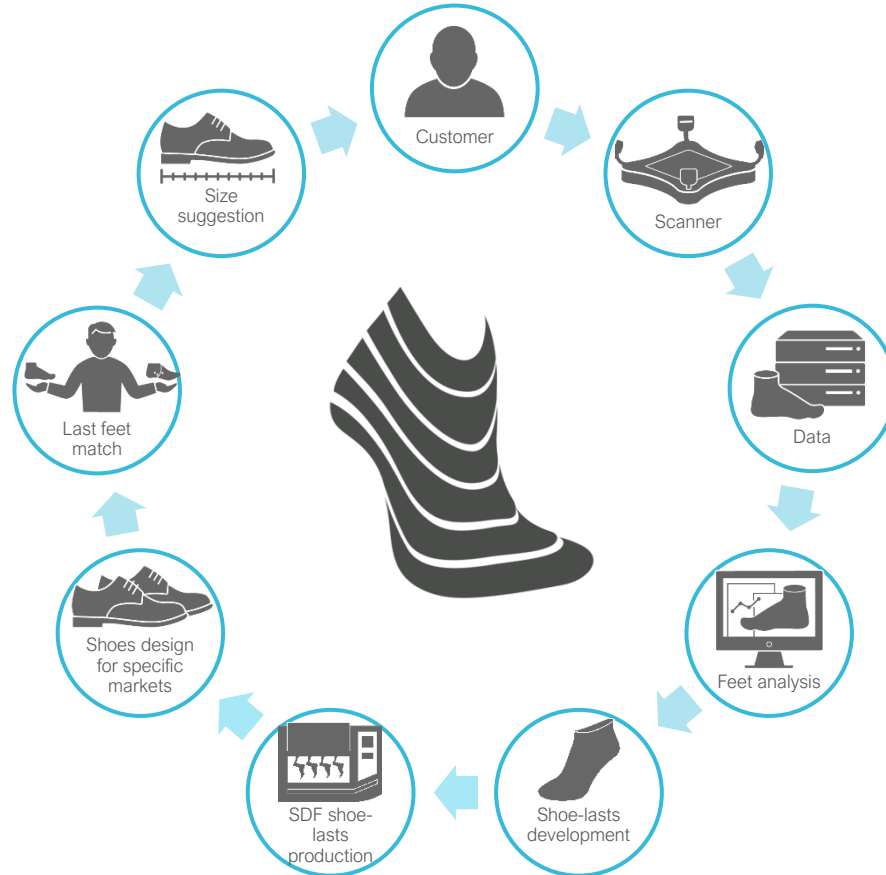

HOW RIGHT SHOES WORKS

Feet scan – Data analysis – Production Optimization - Size suggestion

Scanner Network

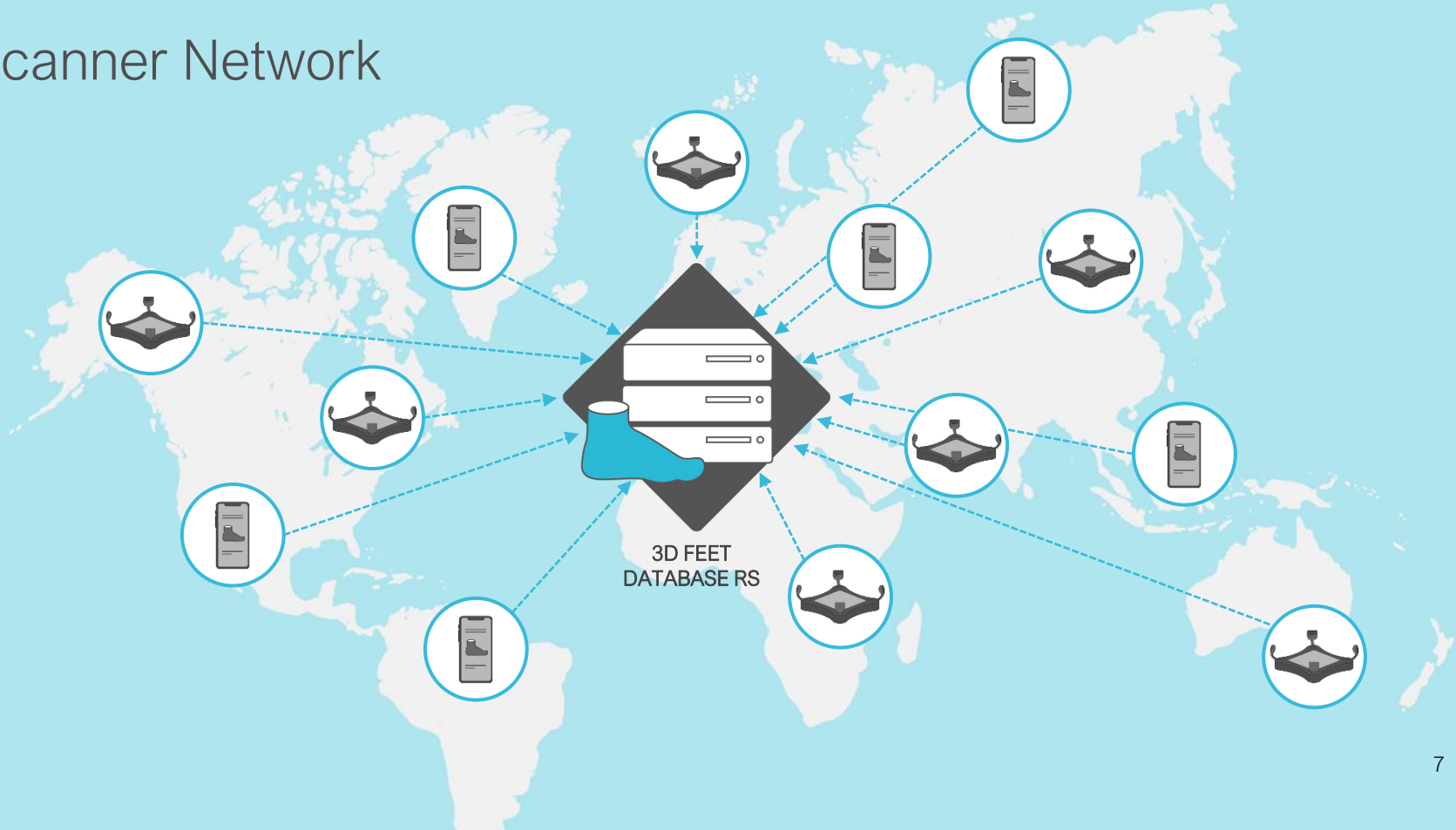

How does Right Shoes works?

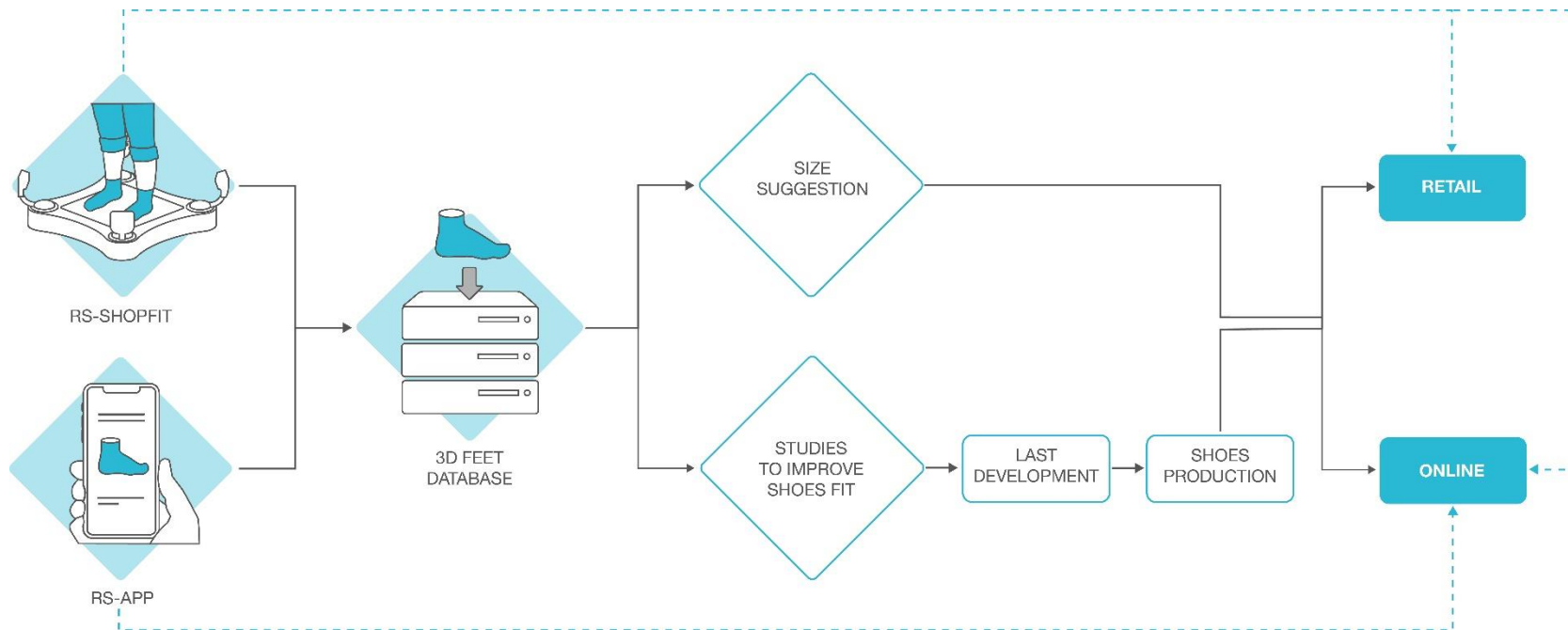

RS-SHOPFIT





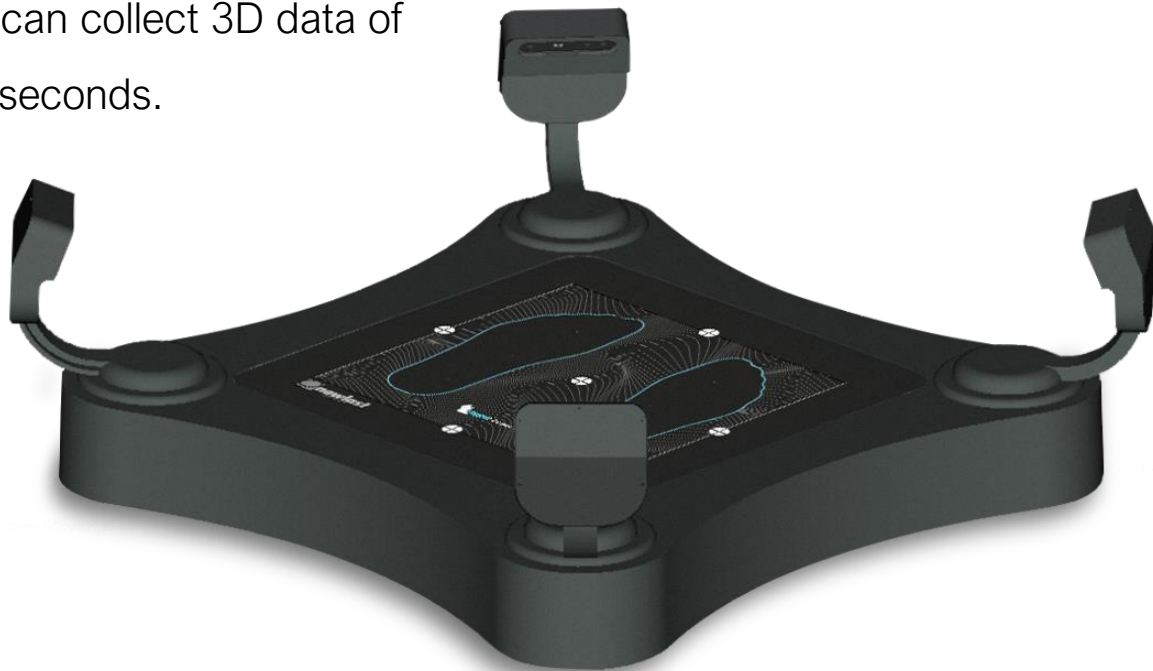

depth camera footscanner

RS-ShopFit

Sensor based foot scanner, can collect 3D data of the customer's feet in a few seconds.



RS-Shopfit characteristics

| | |
|---|--|
|  | Precise and accurate |
|  | Quick and easy scan procedure (3 seconds) |
|  | Rendering and 3D calculation of both feet in just 10 seconds |
|  | Simple and quick installation and configuration. |
|  | Compact and transportable |
|  | Without moving parts |

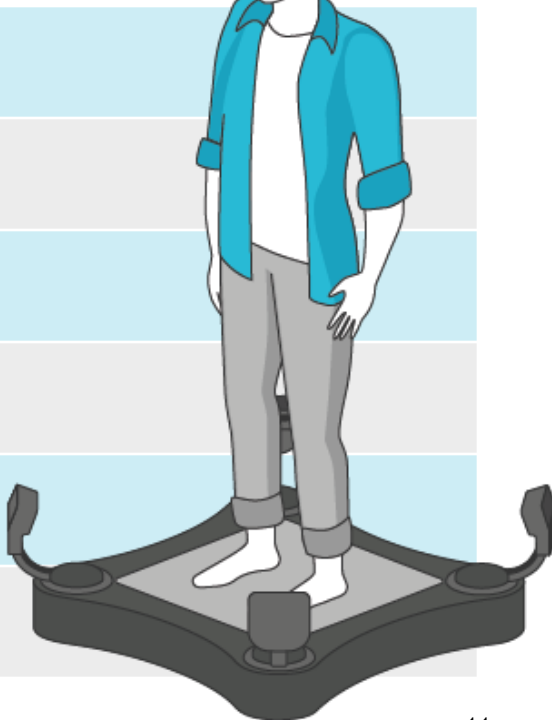

RIGHT SHOES APP

Feet scan with AUGMENTED REALITY

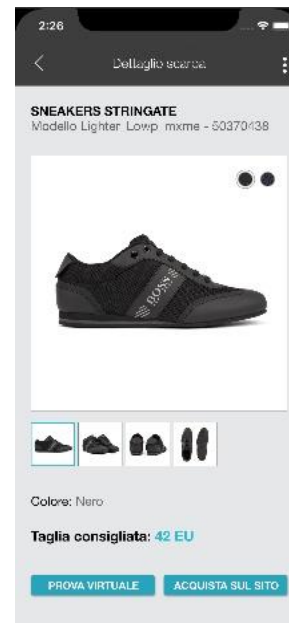
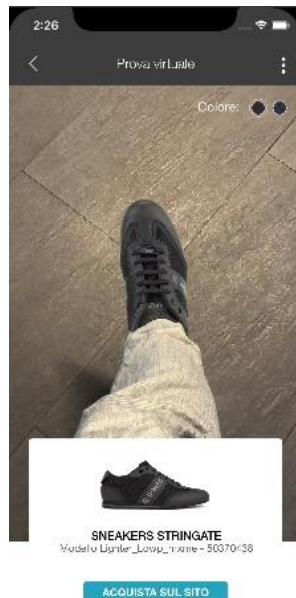

RIGHT SHOES 3D DATA ANALYSIS

a proprietary solution to fit your customers' needs

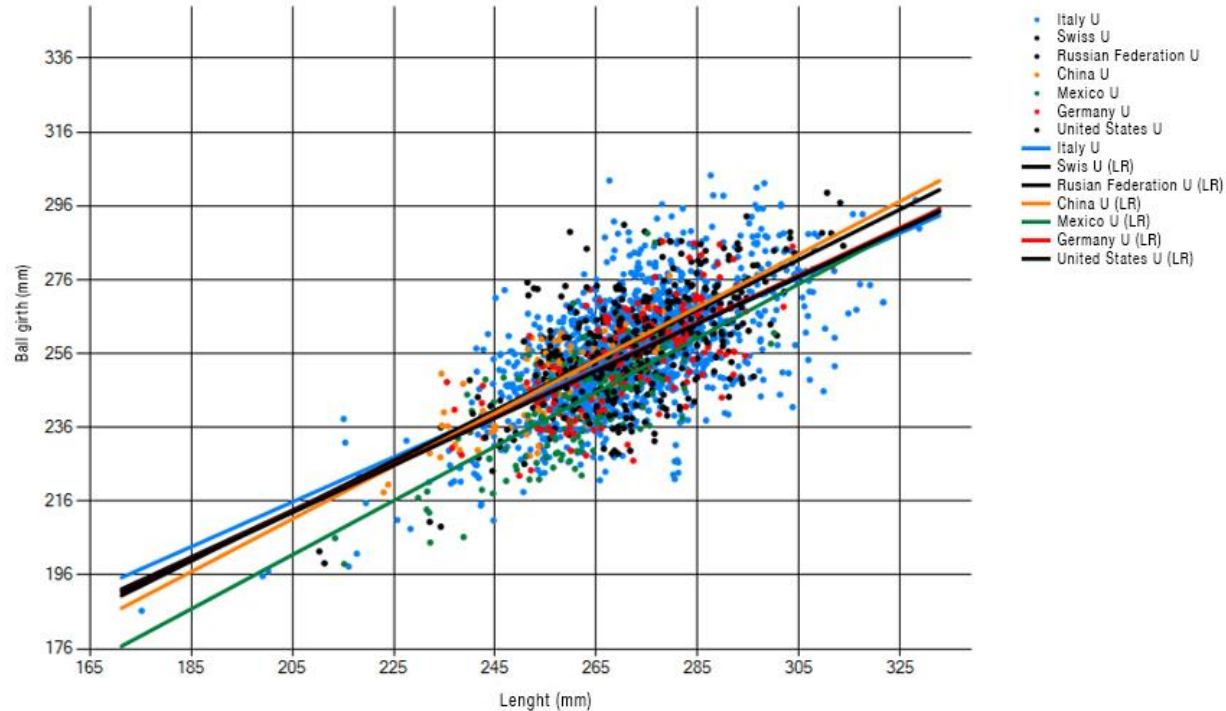

Using Feetmeasure you can create graphs (2D and 3D) to understand the morphological differences according to different variables and measures

3D feet vs 3D last match

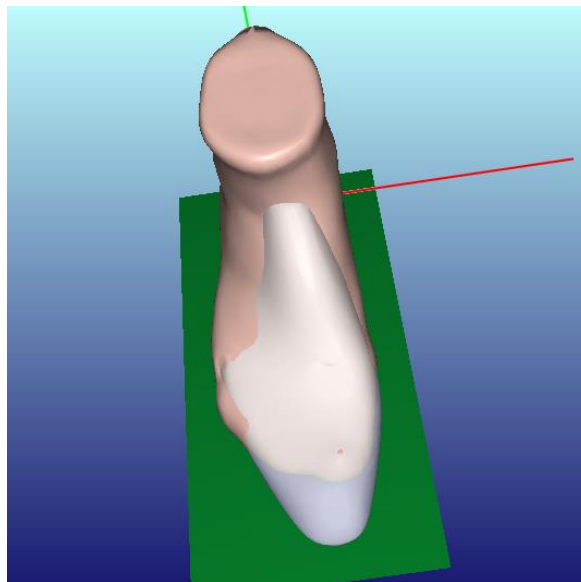
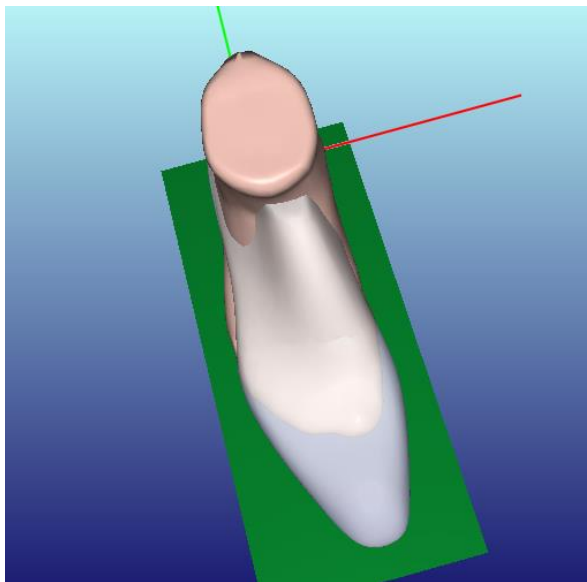

The particular morphological shape of different feet around the world requires different lasts and shoes

Match between Chinese foot and European shoe lasts. There are no chance to have a good fitting because the lasts are designed for different feet with different proportions.

Different markets need different products

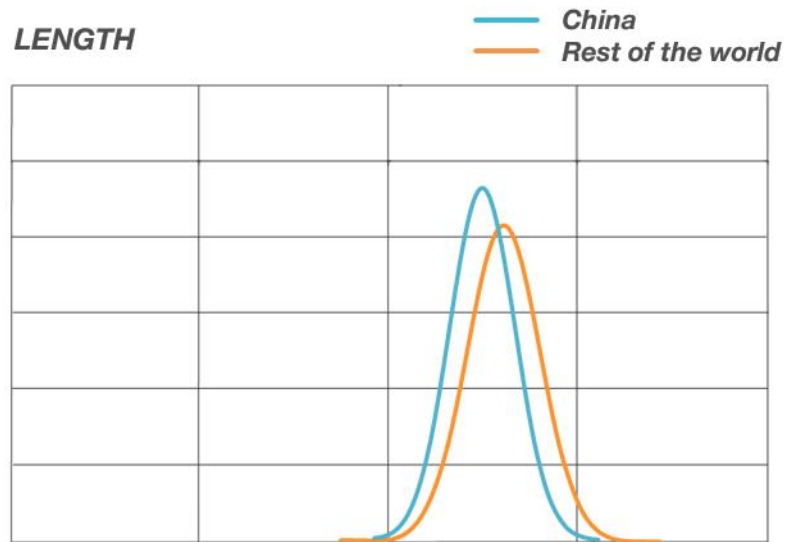
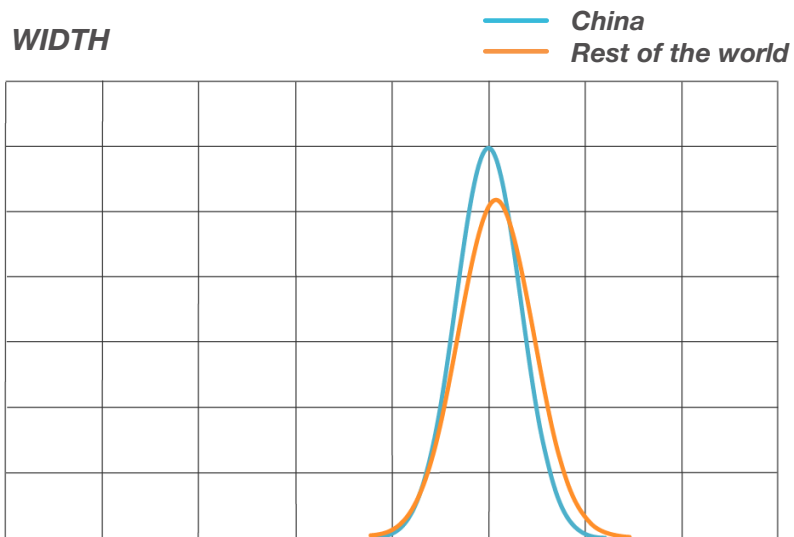

***NEWLAST SDF PROTOTIPATION AND
PRODUCTION KIT***

PROTOTYPING

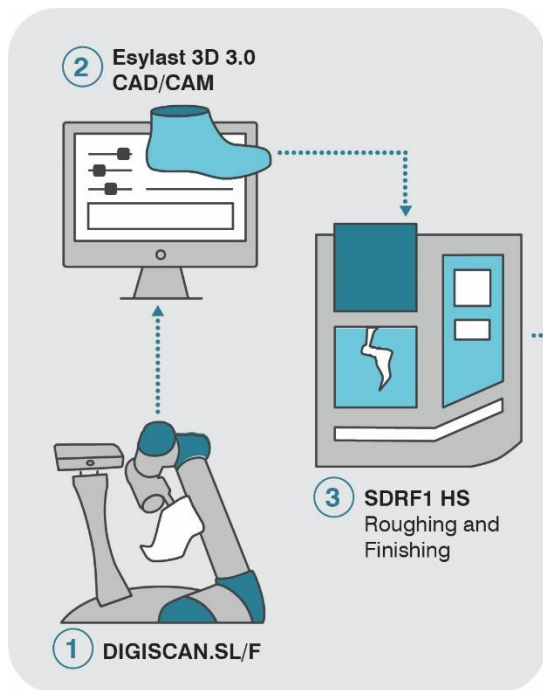

PRODUCTION

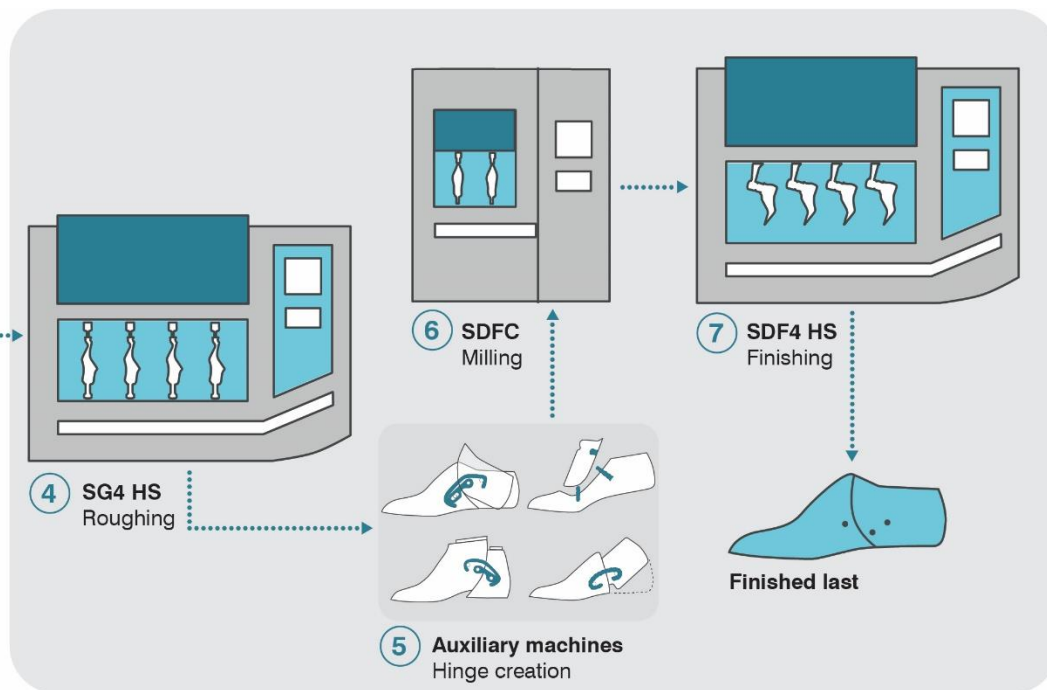

From the very beginning, Newlast Group has been **developing high technology** products, to achieve a **fully integrated process**, which, starting from the last design reaches the sale of the shoe itself, resulting in **high-quality products and customer-oriented service**. Since the 90's, Newlast Group has changed, optimized and automated each phase of the shoe last production, revolutionizing a sector that has long remained anchored to obsolete and manual processing, making it capable of responding effectively to the needs of an increasingly demanding, globalized and computerized market.

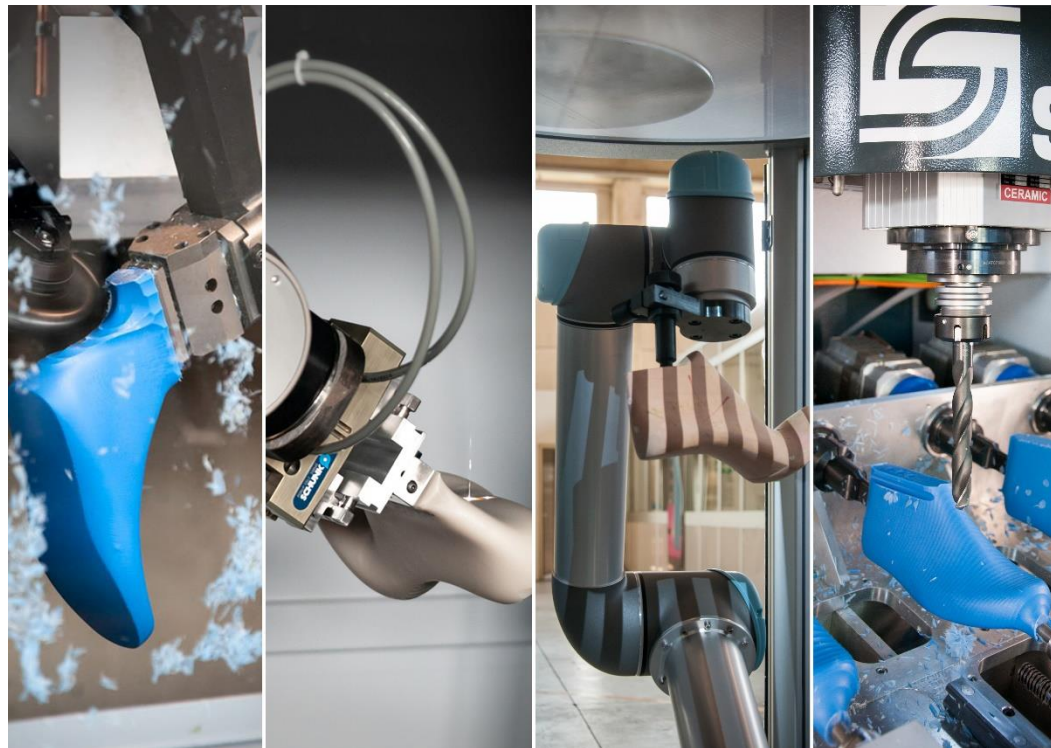

Newlast Italia srl - società
unipersonale-

Via G.Pernigotti 31/a
15057 Tortona – AL -
ITALY

Phone: + 39 0131 894991
Web Site: www.newlast.com
E-Mail: commercial@newlast.com